

FOR LEASE

Heber 6th & Main 600 South Main Street • Heber, Utah



Property Information:

- 1,096 - 2,192 sf available now in multi tenant pad.
- 2,000 - 5,200 sf available with drive thru in future pad.
- Additional Retail, Office and Mid Box Space Available.

Demographics

Demographics	Trade Area
Population	58,959
Households	19,880
Income	Trade Area
Average Household Income	\$101,323
Median Household Income	\$76,791
Per Capita Income	\$34,279

Lisa Vandersteen
lisav@amsource.com
801.741.4530



FOR LEASE

Heber 6th & Main 600 South Main Street • Heber, Utah

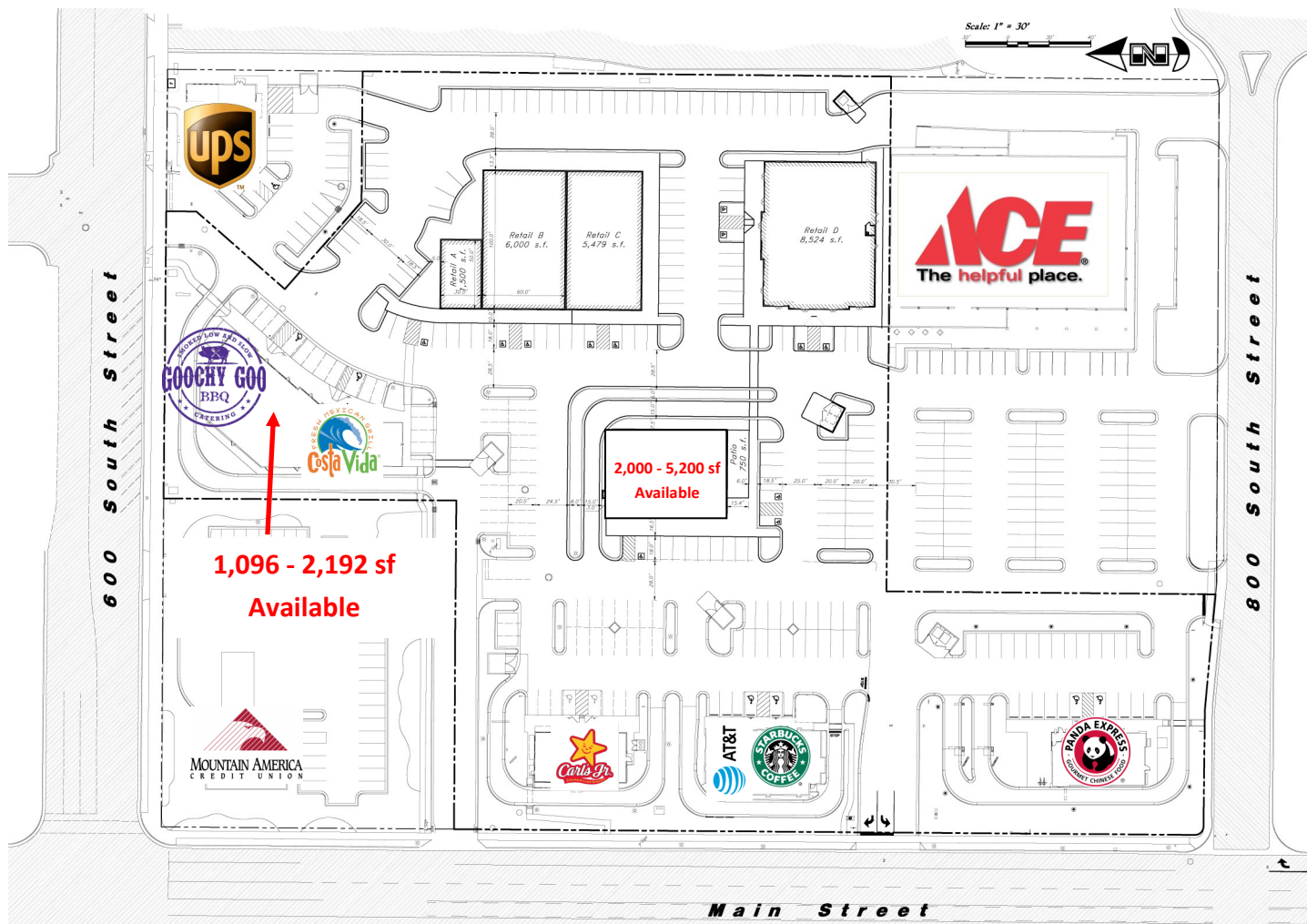

Located just 35 minutes from Salt Lake City and 15 minutes from Park City, Heber City has seen phenomenal growth in its residential population over the past ten years with a 55% population growth! The latest census data shows that Heber City has the fastest growth rate in the state.

In recent years Heber Valley has received 91 Best of State Awards including *Forbes* ranked Heber as the “**Fifth Fastest-Growing Small Town in America**” as well as “**#1 for Business and Careers**”. Heber was also recently recognized as one of “**America’s Hottest Boom**”

Lisa Vandersteen
lisav@amsource.com
801.741.4530

